

5260 & 5560 Exit Bar Lock Installation Guide

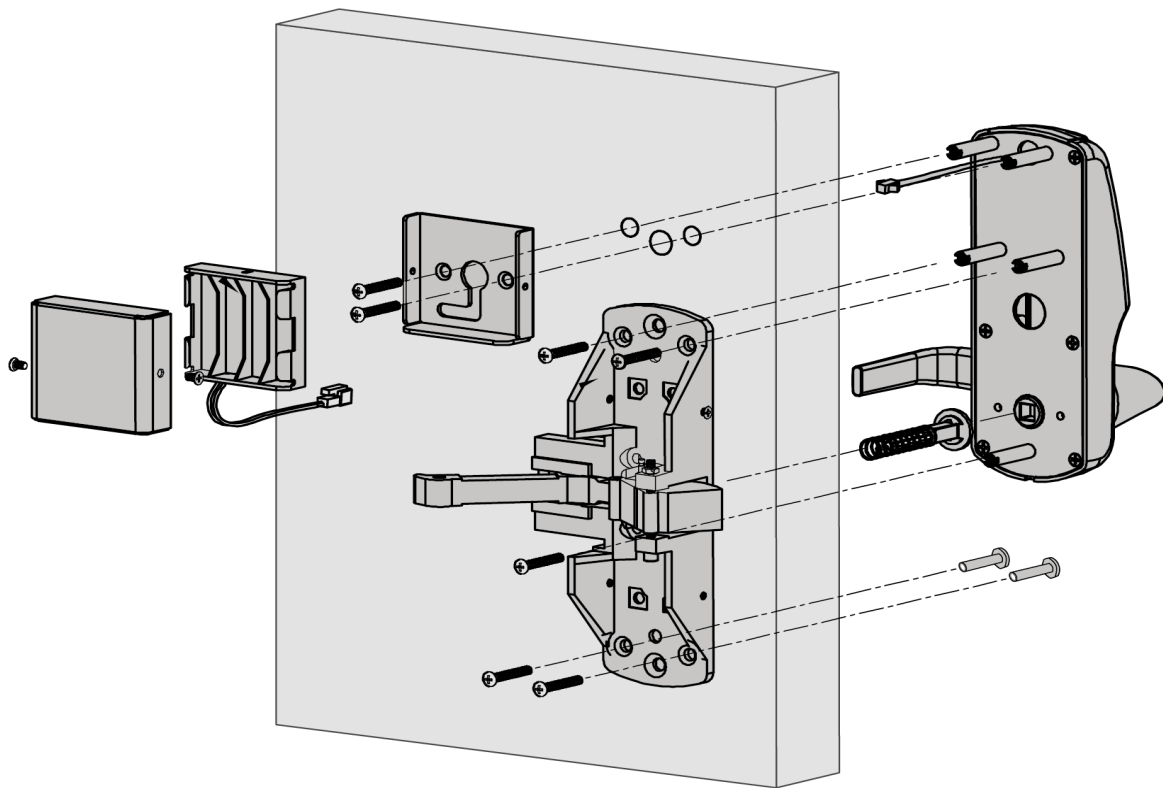

Lock Parts List

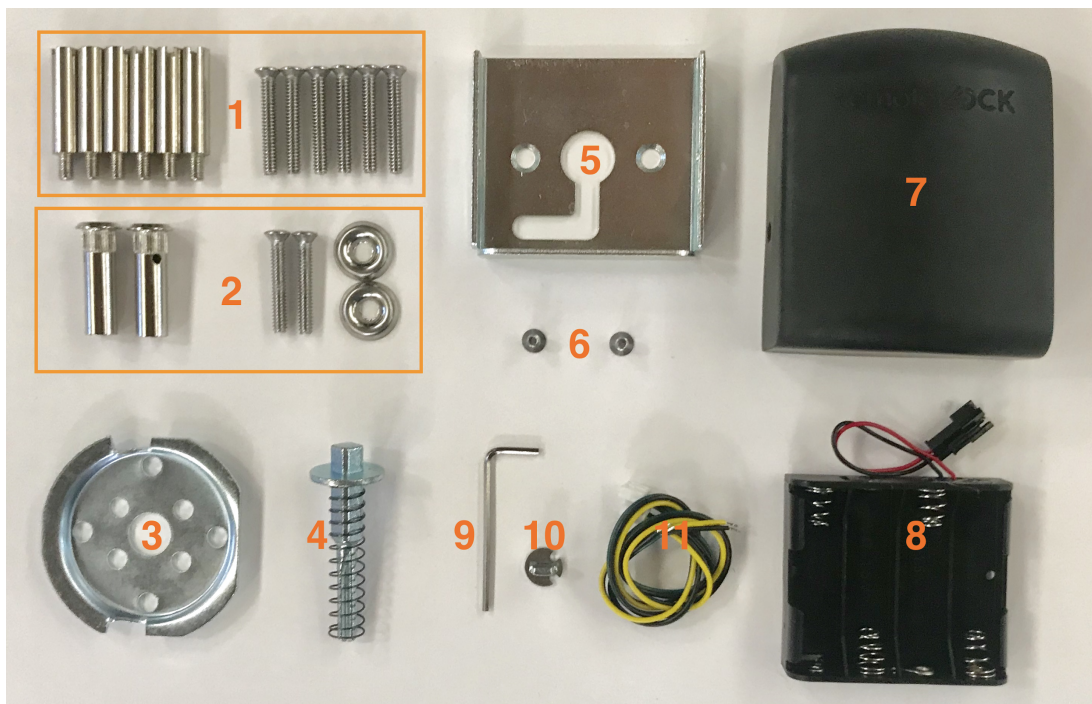

1. 6 support posts and screws
2. 2 Finish Bolts/Washers
3. Retrofit mounting plate if 2 1/8" hole
4. Spindle and spring
5. Battery mounting plate
6. 2 trim screws for battery cover
7. Battery cover
8. Battery pack
9. Allen wrench
10. Classroom mode driver (optional)
11. Dual wires for dry contact (optional)

Prep Lock for Install



Screw in 5 support posts into the keypad side backplate.

Prep Door for Install



Using the drilling template, prep your door to fit the exit bar lock mounting hole requirements. Door pictured here was previously fitted with a lever and deadbolt, so a cover plate will be utilized to cover old cross bore holes.



Use a cover plate if needed to cover exposed holes from previous lock installation.

Front Lock Installation



Fit the front side of the lock onto the door, passing the antenna and power cable through a hole centered between the two upper posts.





Place the spring on the spindle and insert through the door into the front lock hub.



If the door was previously prepared with a 2 1/8" face bore, use the retrofit mounting plate and screw to secure the bottom post of the front lock housing.

Install Panic Bar

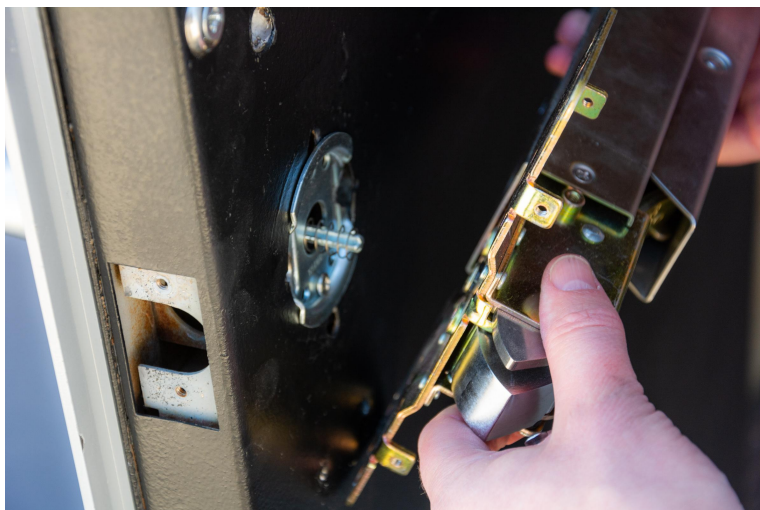

Place the panic bar onto the door interior, fitting the spindle into the panic bar hub.



Secure the top of the panic bar to the mid-posts of the front lock housing with two screws.



Level the panic bar, then secure the bottom chassis with screws. This install uses machine screws directly into the metal door. However, the two finish bolts provided can be used instead to secure all the way through the door.

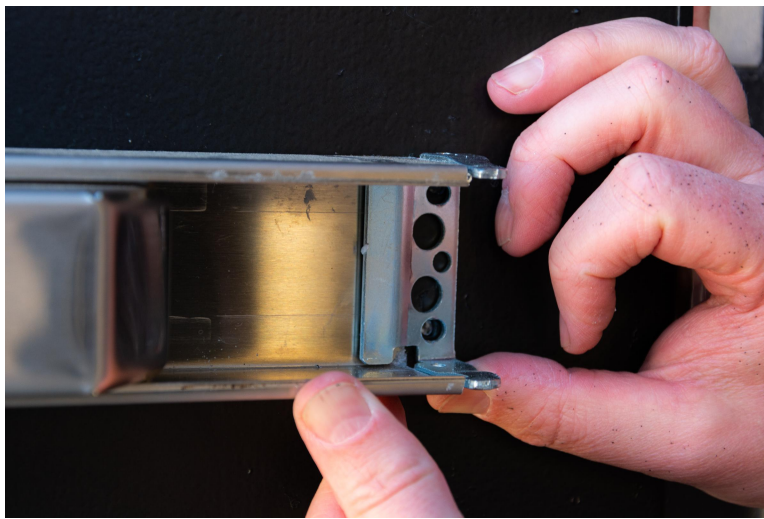

Ensure the panic bar is level, then attach the mounting plate with 3 round head screws.





Attach the end cap to mounting plate with 2 cover screws.

Connect Battery Plate and Cover



Feed the power and antenna cable through the battery mount plate.

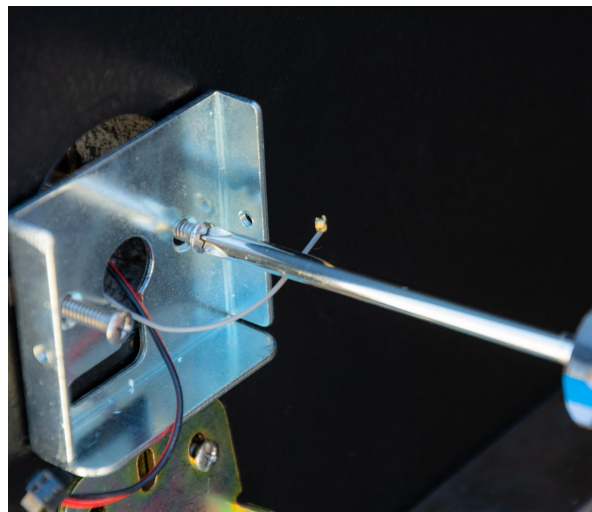

Secure mount plate to the front lock posts with two screws.

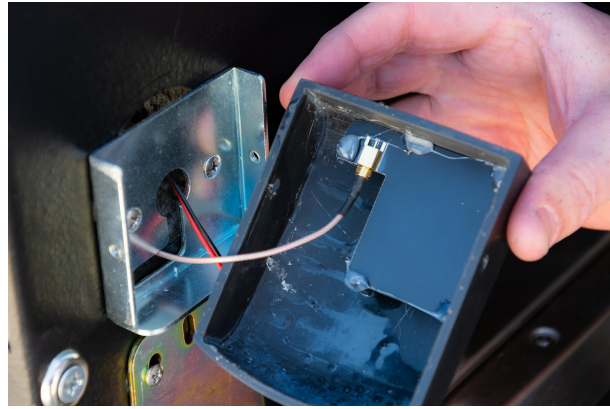
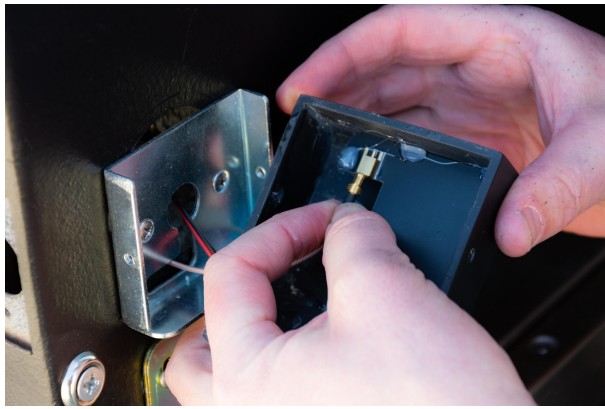

Plug in the antenna cable to the antenna board.

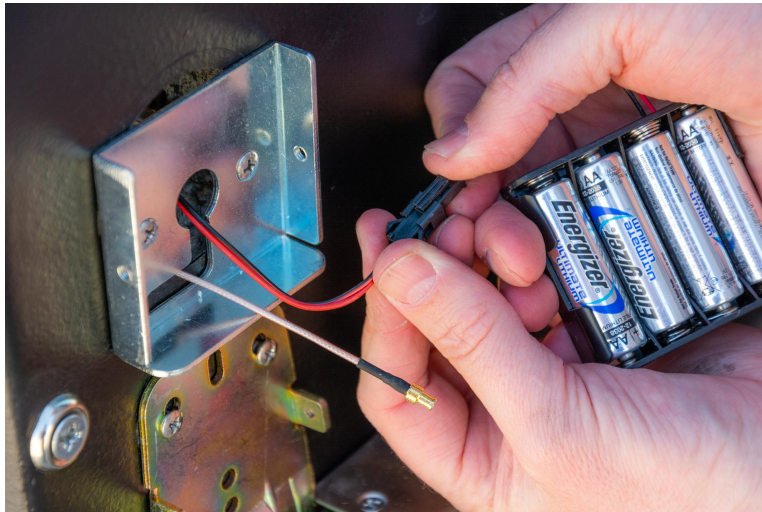

Insert batteries into battery pack and connect the power cable.



Push excess power cable back into the door if room is available.



Place batteries into the battery mount plate.



Place the battery cover over the batteries and mounting plate.

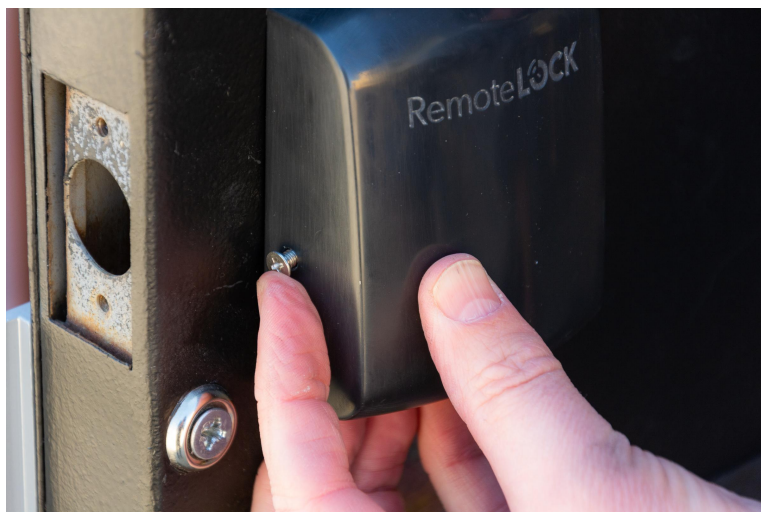

Secure with a small screw on each side of the cover.



Install Panic Bar Latch Cover



Place cover over latch assembly.



Secure with 4 screws.



Install Strike Plate



Drill hole for battery pack

Drill hole for battery pack

Drill hole for battery pack wiring

Drill holes for through bolts

Drill holes if there is no 2 1/8" prep on door

VERTICAL CENTERLINE

1 1/2" (38mm)

3/32" (2mm)

3/8" (10mm)

1/2" (13mm)

3/8" (10mm)

1 17/32" (39mm)

1/2" (13mm)

1/2" (13mm)

5 11/16" (144mm)

3 11/32" (85mm)

7/8" (22mm)

2 1/8" (54mm)

1" (25mm)

3/8" (10mm)